

# GLASSBOAT

CORPORATE

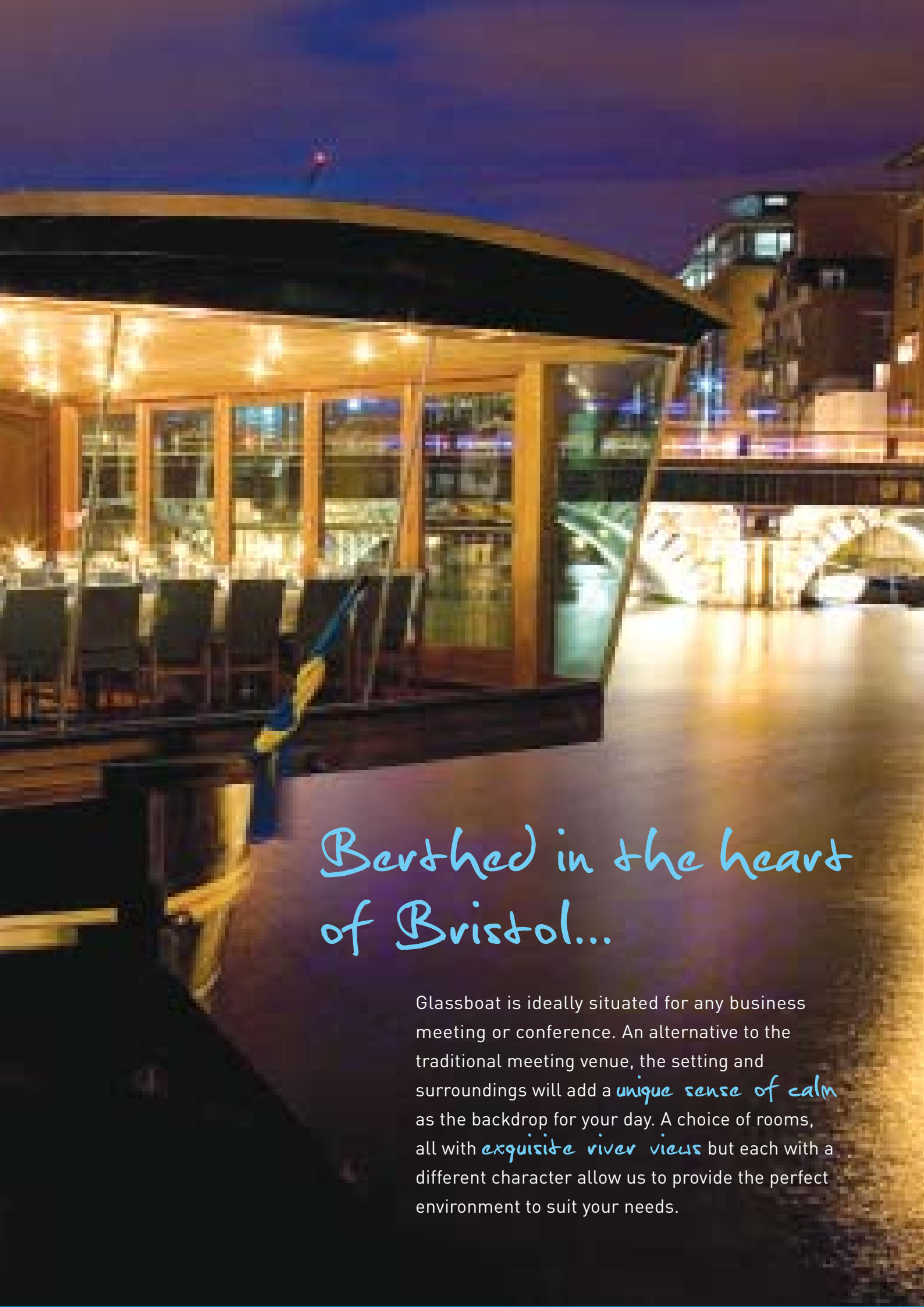

## Berthed in the heart of Bristol...

Glassboat is ideally situated for any business meeting or conference. An alternative to the traditional meeting venue, the setting and surroundings will add a *unique sense of calm* as the backdrop for your day. A choice of rooms, all with *exquisite river views* but each with a different character allow us to provide the perfect environment to suit your needs.



# Rooms and Seating Plans

## PRIVATE LOWER DECK

With a polished wooden deck, sculptured oak surrounds and portholes lining each side of the hull, it's easy to see why this is a unique room and something special in comparison to the traditional meeting room. This room is suitable for any type of meeting or event of up to 60 delegates.

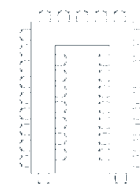
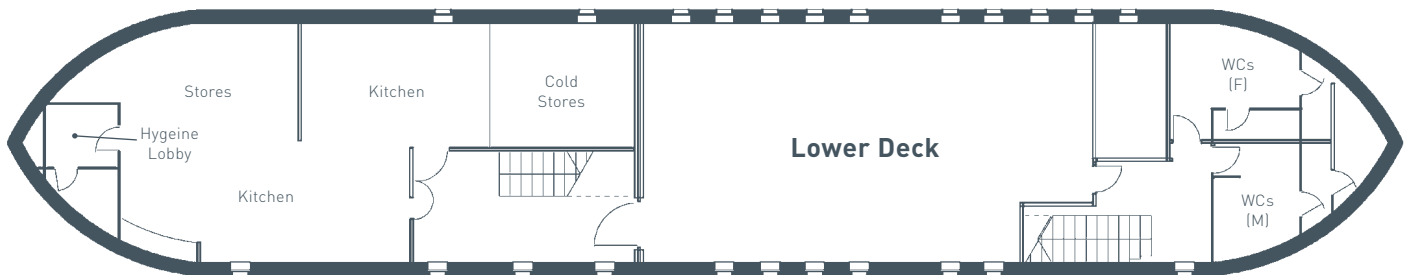

**U shape**  
37 seats



**Banquet**  
40 seats



**Boardroom**  
28 seats

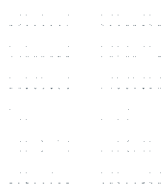

**Theatre**  
48 seats



**AFT SECTION**

Our completely glazed aft section with stunning views over the river is a distinctive setting and certainly offers you a change from the traditional meeting room. This area is suitable for any type of meeting of up to 60 delegates or guests.

**THE LOUNGE**

Situated at the stern of the boat, our lounge area complete with leather chairs and a well stocked back bar is ideal for an informal gathering or event over drinks. It can also accommodate seated parties of up to 40 delegates.

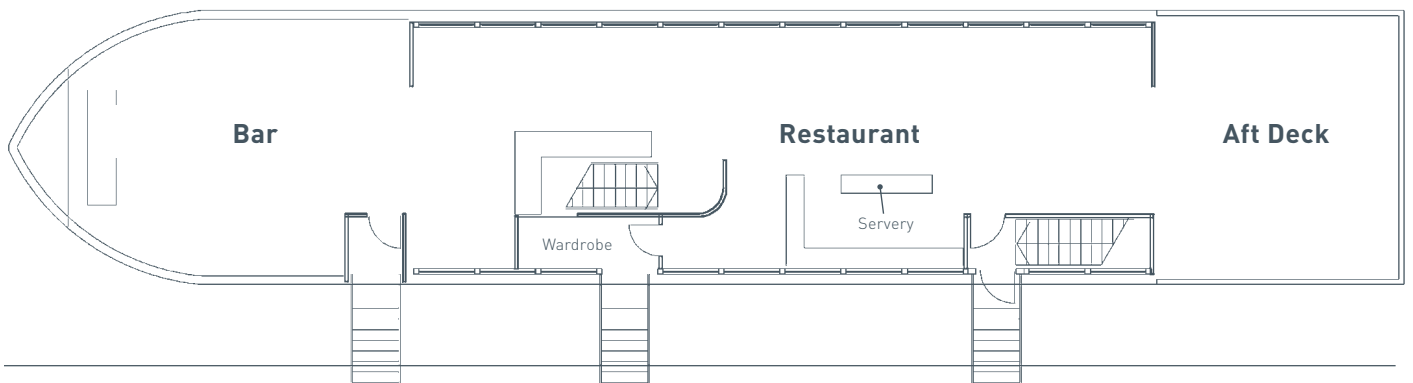

	<b>U shape</b> 36 seats	<b>Open centre Boardroom</b> 36 seats	
<b>Boardroom</b> 32 seats	<b>Ceremony / Theatre</b> 50 seats	<b>Banquet</b> 56 seats	



CORPORATE

*"Above all I would highly recommend the Glassboat Restaurant in Bristol. We have held luncheons there on a regular basis and held last years Christmas party there. The food, quality of service and staff were, and are continuously, above excellence - to be recommended time and time again"*

AMANDA PAYNE, ENGLISH HERITAGE

#### BESPOKE RATES

We pride ourselves on our flexibility. Our events organiser will happily build a bespoke package to suit your needs and quote accordingly. All rooms are subject to minimum spends depending on the time & day of week.

#### EVENTS MANAGER

Our Events Manager is on hand to help you plan and organise your event down to the smallest of details. They're in place to make sure it goes off without hitch and remove the hassle and stress that can come with planning an event or meeting.

They're also your dedicated contact on the day, leaving you to get on with your meeting or event and ensuring that your experience is one to remember.

#### EQUIPMENT

As you'd expect from any good venue we can supply any AV equipment you may need and ensure that it's in place and ready to go before you arrive. Prices will be quoted on request or at time of your enquiry.

#### SPECIAL REQUIREMENTS

As all events and meetings are different we appreciate that in some cases you may have certain special requirements and we're more than happy to accommodate them. Our dedicated Events Manager is on hand to discuss these with you so please don't hesitate to ask at the time of your enquiry and we'll do whatever it takes to ensure your needs and wants are met.

#### FOOD

Should you want to include a meal with your event or meeting, you're in the perfect venue. Our restaurant has a modern Mediterranean influenced menu, packed with vibrant yet simple dishes to suit any palette. Prepared using creative combinations of the finest ingredients and with the salads, vegetables and herbs delivered daily from our very own kitchen garden.

#### STANDARD RATES

##### **Breakfast Meetings £17.50 per person**

Available from 7.30am – 10am. This includes use of the lower deck, tea, coffee, mineral water or orange juice & a choice of breakfast dishes, toast & preserves. Stationary, flipchart, Wi-Fi Access and screen are also included.

##### **Half Day Hire £20 per person**

Available between 8am & 12pm or 12pm & 6pm. This includes use of the lower deck, tea, coffee, mineral water or orange juice. Stationary, flipchart, Wi-Fi Access and screen are also available.

##### **Full Day Hire £37 per person**

Available between 8am – 6pm. This includes exclusive use of the lower deck, tea, coffee, mineral water or orange juice. You'll also enjoy a selection of pastries to fill the gap between lunch! As you'd expect from any meeting venue, paper, pens, flipchart, Wi-Fi Access and screen are also available.

#### EXTRAS

Breakfast can be added from £8 per head for our 3 choice menu plus toast & preserves. Lunch can be added from £10 per head for 2 courses and is served on the upper deck in the restaurant.

Any AV can be added and prices quoted upon request.



WELSH BACK BRISTOL BS1 4SB  
TEL 0117 929 0704  
EVENTS@GLASSBOAT.CO.UK  
GLASSBOAT.CO.UK